

# Model I Weld

## Engineering Information:

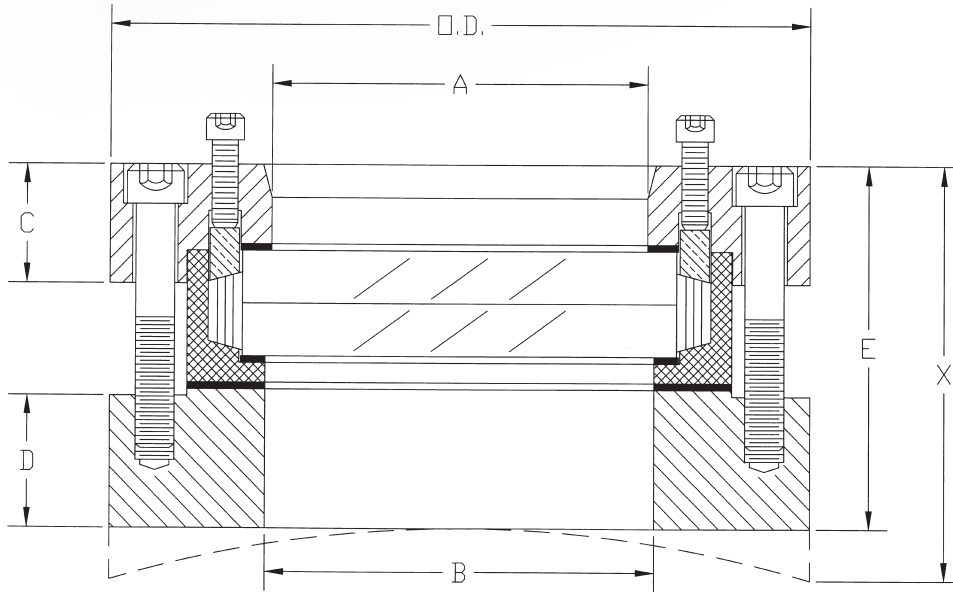

Size inches-psi	O.D.	A	B	C	D	E
2-150	4 3/4	1 3/4	1 15/16	1	1 1/4	3 3/16
2-300	4 15/16	1 3/4	1 15/16	1 1/8	1 1/4	3 9/16
2-600	5 1/8	1 3/4	1 15/16	1 1/8	1 1/2	3 15/16
3-150	5 3/4	2 5/8	2 7/8	1 1/8	1 1/4	3 7/16
3-300	5 15/16	2 5/8	2 7/8	1 1/4	1 3/8	3 13/16
3-600	6 1/8	2 5/8	2 7/8	1 3/8	1 5/8	4 11/16
4-150	6 3/4	3 5/8	3 3/4	1 1/4	1 1/4	3 15/16
4-300	7	3 5/8	3 3/4	1 3/8	1 1/2	4 3/16
4-600	7 1/4	3 5/8	3 3/4	1 1/2	2	5 5/8
6-150	9	5 1/2	5 3/4	1 1/2	1 1/2	4 5/16
6-300	9 1/4	5 1/2	5 3/4	1 1/2	1 3/4	5 3/16
8-150	11 1/8	7 3/8	7 11/16	1 1/8	1 1/2	4 11/16
8-300	11 1/2	7 3/8	7 11/16	1 9/16	1 3/4	5 7/16

- The Model I Weld unit can be supplied with a radius (cylindrical or spherical) to match vessel or head. The "D" dimension will vary depending on the vessel radius.
- The I Weld is designed in accordance with ASME Pressure Vessel Code (Section VIII, Division I) to be self-reinforcing to the vessel shell, depending on the vessel characteristics, operating conditions and size of the sight glass desired. To ensure area requirements for self-reinforcement, the unit must be designed for its specific use.